

Innovative key features of F540/560

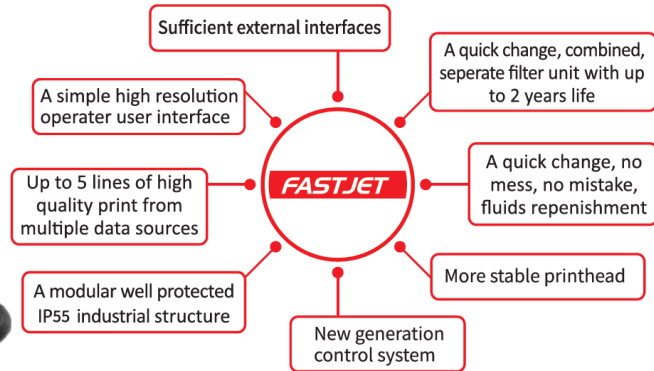

F540/560 SPECIFICATION AND CONFIGURATION

	F540	F560
Nozzle	70/60 µm	70/60/50/40 µm
Maximum Vertical Drops	25	34
Chinese Font Library	●	●
Multi-language	●	●
Traversing Printing	●	●
90 Degrees Vertical Printing	●	●
IP55 Industrial Protection	●	●
Special Counter	●	●
Clock Replacement	●	●
Encoder Port	●	●
USB Port	●	●
Serial Port	○	○
Ink Recovery Pump		
Positive Air Pump	○	○
Solvent Flush Pump	●	●
High Speed Model		●
Dye Ink	●	●
Soft Pigment Ink and corrosiveink (Adopted by certain models, please consult the manufacturer)	○	●
Consumables:	Ink types: dyes, light pigments Ink color: black, red, etc. Special inks: anti-migration, soft pigments, etc., refer to the ink list for details	MAKEUP: select according to ink type Cleaning agent: select according to ink type
Umbilical	Length: 2700mm Diameter: 21mm Bending Radius:150mm	
Print Height	1.2-15 mm	
Max Printing Speed	320 m/meter	
Printing Distance	2-15 mm	
Input System	Standard American Keyboard of WYSIWYG	
Print Font	5x5, 7x5, 9x7, 11x9, 16x11, 24x16, 32x24, 6x5, 9x6 (bold), 11x8 (bold)	
Operating Range	5-45 Deg C	
User Defined Field	Bar Code, QR Code, Logos, Clock, Counter, Classes, etc	
Electricity	200-240 VAC, 50HZ	
Power	120-150 W	
Net Weight	27kg	
Gross Weight With Complete Package	45kg	

Note: The "●" in the above table stands for "standard", and the "○" stands for "optional".

CONTACT US: SCS INKJET CODING SOLUTION | PT. Sumber Cipta Solusi

Address Komplek Daan Mogot Baru, Jl Jimbaran Blok LA 14 No 6., Jakarta Barat 11840

Phone (021) 544 1932; 540 8937; 0812 992 8351 / 081806433959

Email marketing@scsmarking.com / alexanderglenn@scsmarking.com

Website: www.SCSMarking.com

Key features and benefits of F540/560

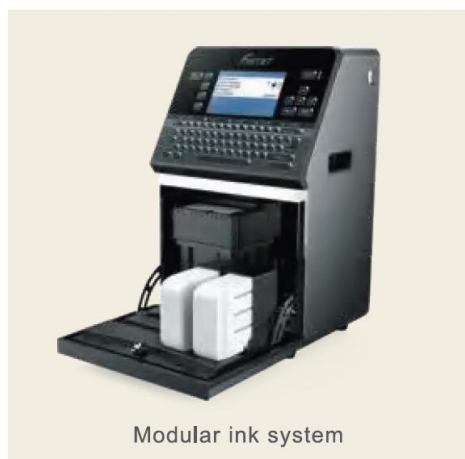

Modular ink system

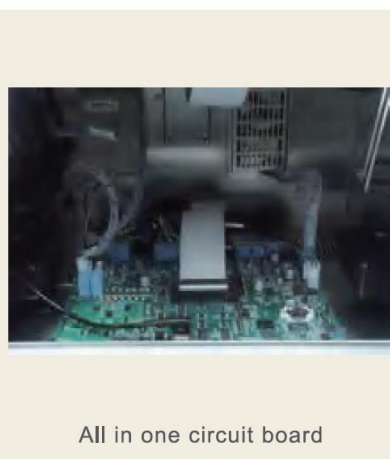

All in one circuit board



Quick addition



More stable printhead

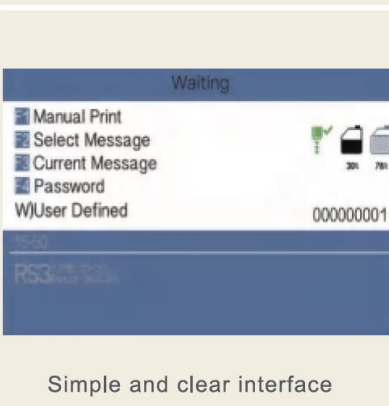

Simple and clear interface



Simple and quick maintenance

Printing samples

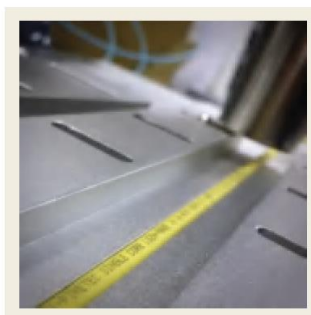

CONTACT US: SCS INKJET CODING SOLUTION | PT. Sumber Cipta Solusi

Address Komplek Daan Mogot Baru, Jl Jimbaran Blok LA 14 No 6., Jakarta Barat 11840

Phone (021) 544 1932; 540 8937; 0812 992 8351 / 081806433959

Email marketing@scsmarking.com / alexanderglenn@scsmarking.com

Website: www.SCSMarking.com

- Industrial aesthetics and modular design, and IP55 protection level improve the stability of machine.
- The new generation operating system is equipped with three printing modes of high quality, standard and high speed that can be switched arbitrarily to meet the needs of different industries.
- The F560 series CIJ has both models adapted to general purpose inks and models adapted to special inks such as anti-migration and soft pigments. which is optional The entire series is available in 750ml , reducing operating costs.
- The optimized and upgraded printheads integrate modules such as heating, phase detection and amplification, positive air pressure output, high voltage insulation and printhead valves adapted to pigment ink, whereas the stability of the printhead is greatly improved.
- A variety of optional external interfaces, including serial ports, USB ports, expandable input and output IO ports, and so on, can be used to connect , industrial controllers, PLCs, code scanners, and weighing instruments for the equipment interconnection, information exchange and mutual control.

■ Dimensions

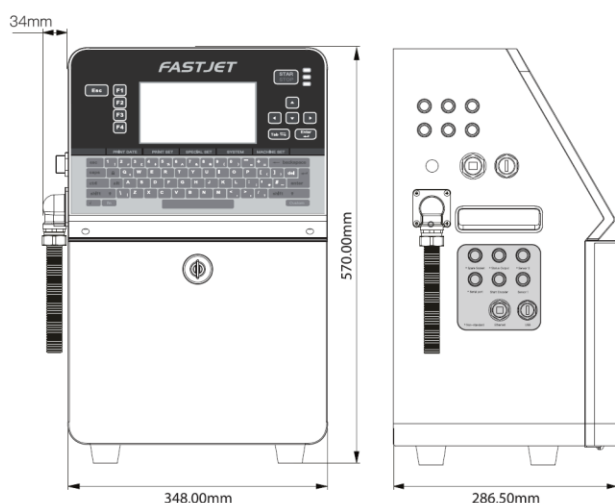

■ Printhead

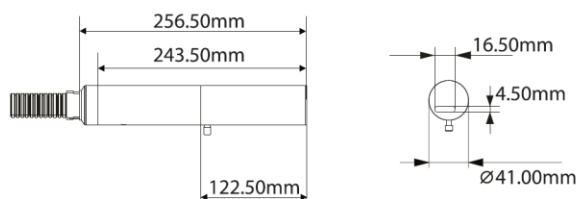

CONTACT US: **SCS INKJET CODING SOLUTION | PT. Sumber Cipta Solusi**

Address Komplek Daan Mogot Baru, Jl Jimbaran Blok LA 14 No 6., Jakarta Barat 11840

Phone (021) 544 1932; 540 8937; 0812 992 8351 / 081806433959

Email marketing@scsmarking.com / alexanderglenn@scsmarking.com

Website: www.SCSMarking.com